

NC-1199-1

Long-Arm Zipper-Sewing Station

Sewing station from Nähtec simultaneously attaches zipper halves to mattress top and bottom panels.



SPECIFICATIONS	NC-1199-1
Arm length	38in (965 mm)
Rate	Up to 2 panels per minute

The NC-1199-1 long-arm zipper-sewing station is the perfect solution for simultaneously attaching zipper halves to mattress top and bottom panels.

- Twin-needle, long-arm machine with top and bottom thread trim.
- Power pulley ensures even and accurate sewing.
- Pneumatic needle positioning and sewing foot lift with automatic puller control.
- Automatic back-tacking.
- Zipper separator, guide, and unwinding station.
- Large work table with adjustable height.

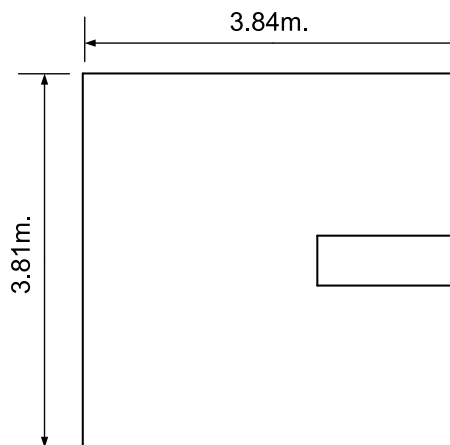

Global Systems Group® (GSG) is a collection of the world's leading mattress machinery companies. These GSG machinery companies represent leading-edge technology in computerized quilting machines and panel cutters, automated and conventional sewing machines, material handling solutions, and mattress-packaging equipment.

800-343-8138 • 417-237-6254 • GSGcompanies.com



A DIVISION OF LEGGETT & PLATT

131 Zapletal Way
Carthage, MO 64836 USA

TEKNOMAC

MERELLO
NGEN EROSLI

quarrata
forniture

NÄHTEC

S.P.U.H.L
ANDERSON

GALKIN

G
Gribetz International

Gateway
SYSTEMS

Porter
INTERNATIONAL